

RED RIVER ARENAS.com

“Spend Less, Get More!”

800-343-1026

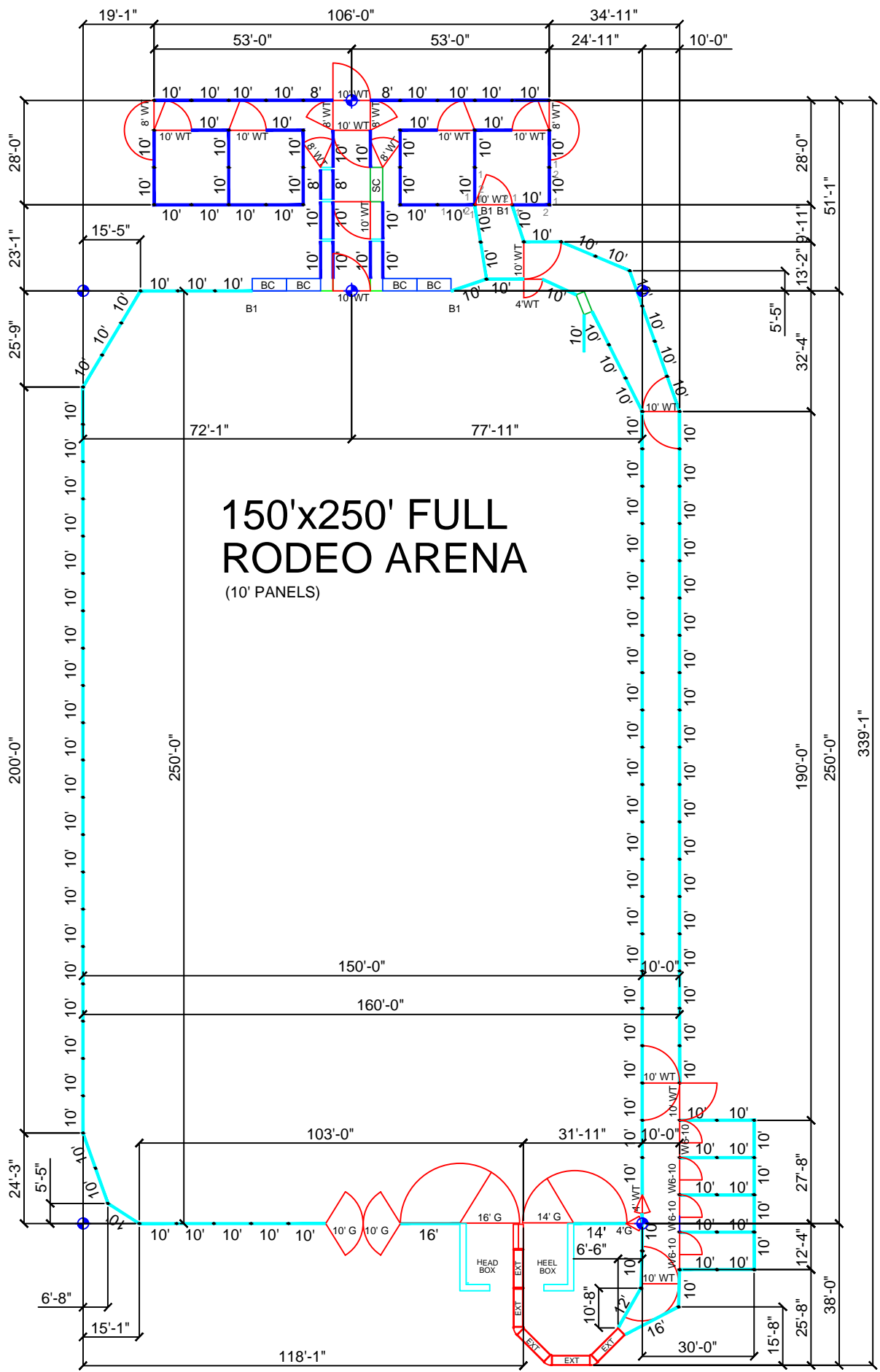

150' x 250' FULL RODEO ARENA EXCAVATION AREA

MINIMUM EXCAVATION AREA IS 190'-0" BY 349'-1"

- 1 Start by staking out the Alley Entrance (WalkThrough Gate) and Bucking Shoots
(This will help in squaring off the Bucking Shoots and the overall Arena.)

NOTE: IF EXCAVATION EXCEEDS THE GIVEN DIMENSIONS OWNER
WILL NEED TO COMPENSATE ACCORDINGLY

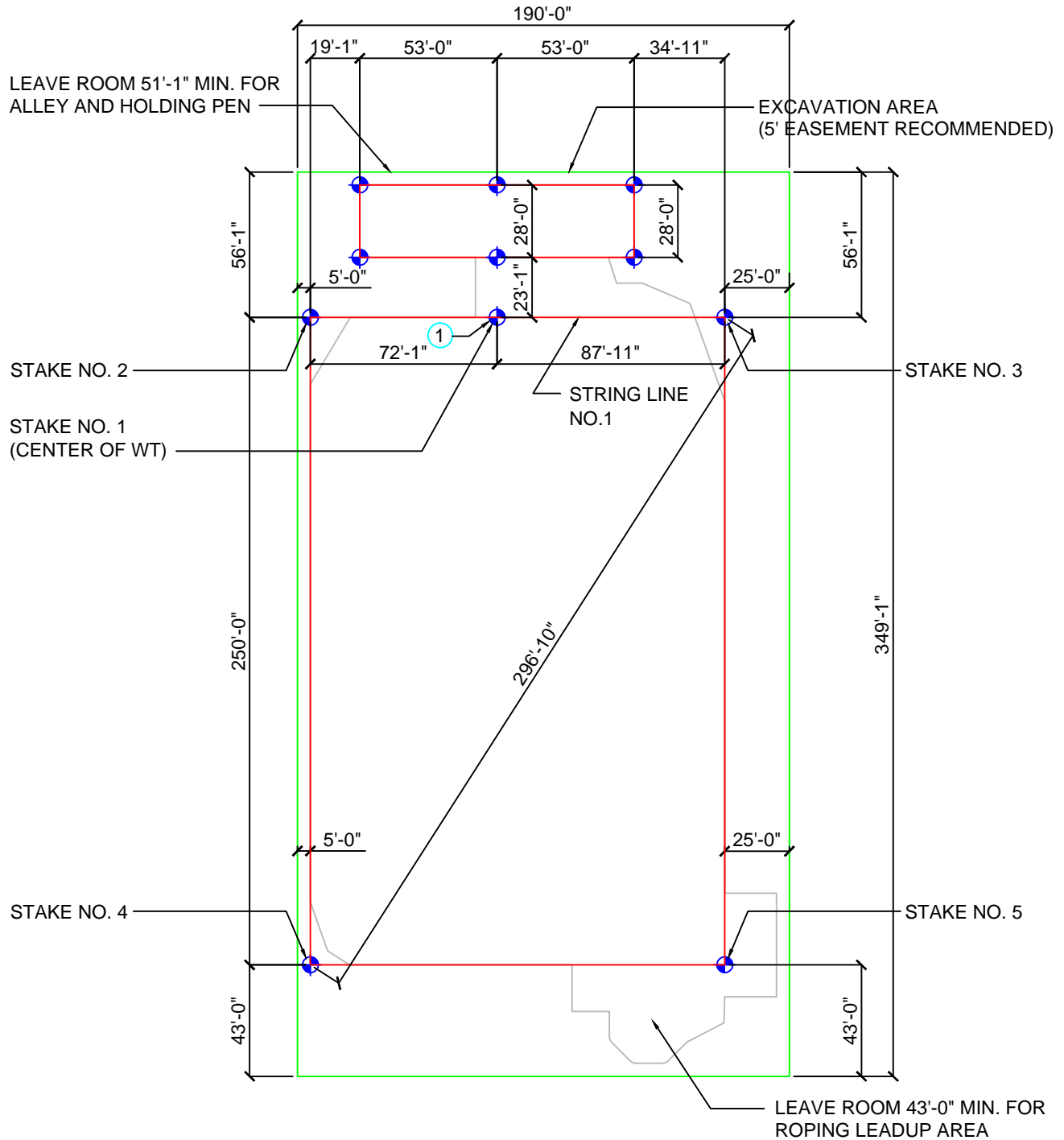

150' x 250' BUCKING ARENA MAIN ALLEY ENTRANCE

- ④ Using the Face of the L-Sections, run a string line to the Back WalkThrough.
(This will help in lining up the Slidders, Walkthroughs and Stripping Chute.)

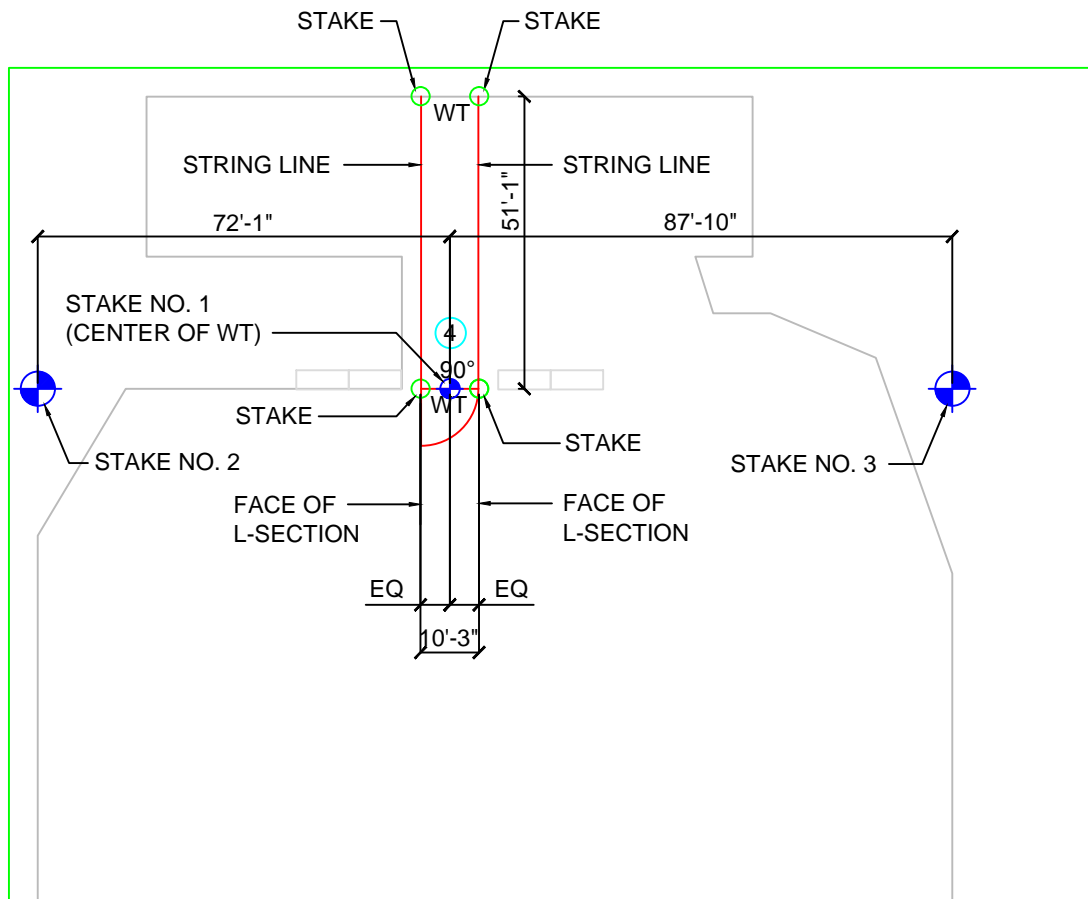

150' x 250' FULL RODEO ARENA BUCKING CHUTE PLACEMENTS

- ② Place L-Sections and 10' WalkThrough using Stake No. 1 to locate Center of Gate.
(Use string line no.1 to line up 10' WT and L-Sections.)
- ③ Place ALL Bucking Chutes and align with WalkThrough and L-Sections.
(Use string line no.1 to line up Bucking Chutes.)

**NOTE: DOUBLE AND SINGLE SPOOLS ARE USED TO CONNECT ITEMS TOGETHER.
IF THE SPOOLS DO NOT MATCH A CONNECTION PLEASE VERIFY
CORRECT ITEM AND ORIENTATION ARE BEING USED.**

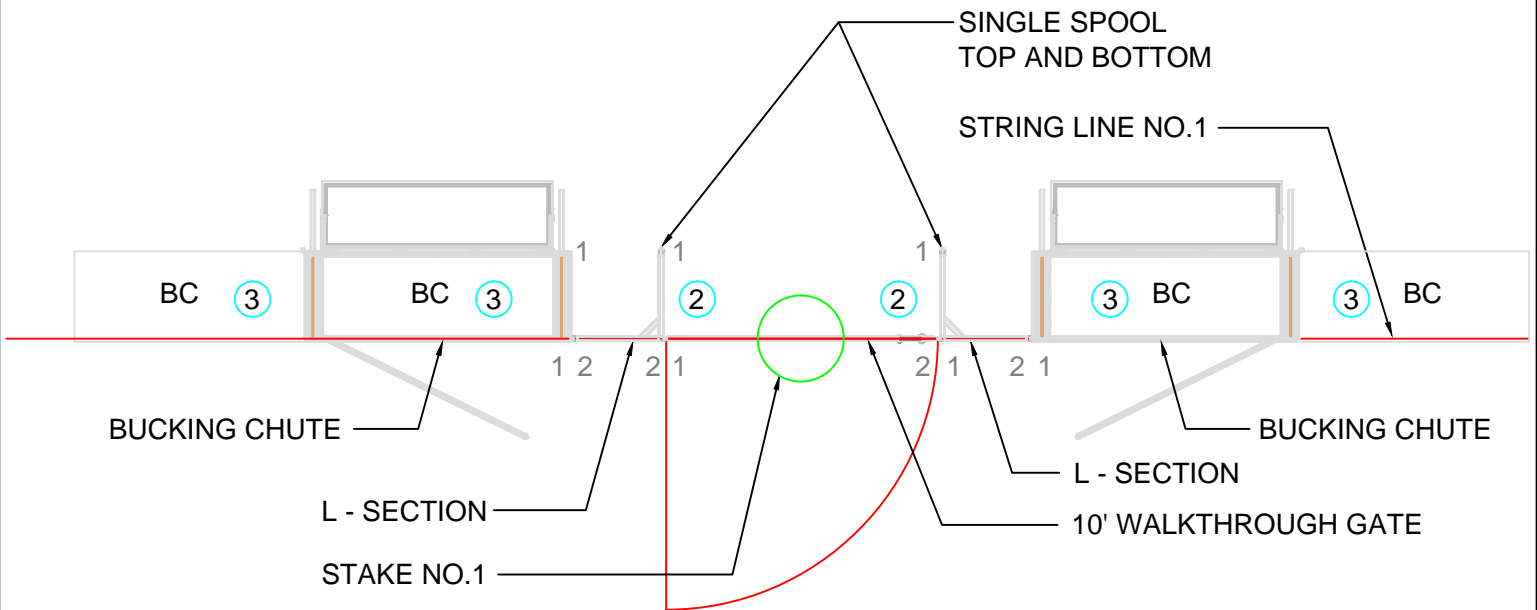

150' x 250' FULL RODEO ARENA BUCKING CHUTE SPOOL CONNECTIONS

- ② Place 10' WalkThrough and L-Section and Bucking Chutes using Stake No. 1 to locate Center of Gate.
(Use string line no.1 to line up 10' WT and L-Sections and Bucking Chutes.)

**NOTE: DOUBLE AND SINGLE SPOOLS ARE USED TO CONNECT ITEMS TOGETHER.
IF THE SPOOLS DO NOT MATCH A CONNECTION PLEASE VERIFY
CORRECT ITEM AND ORIENTATION ARE BEING USED.**

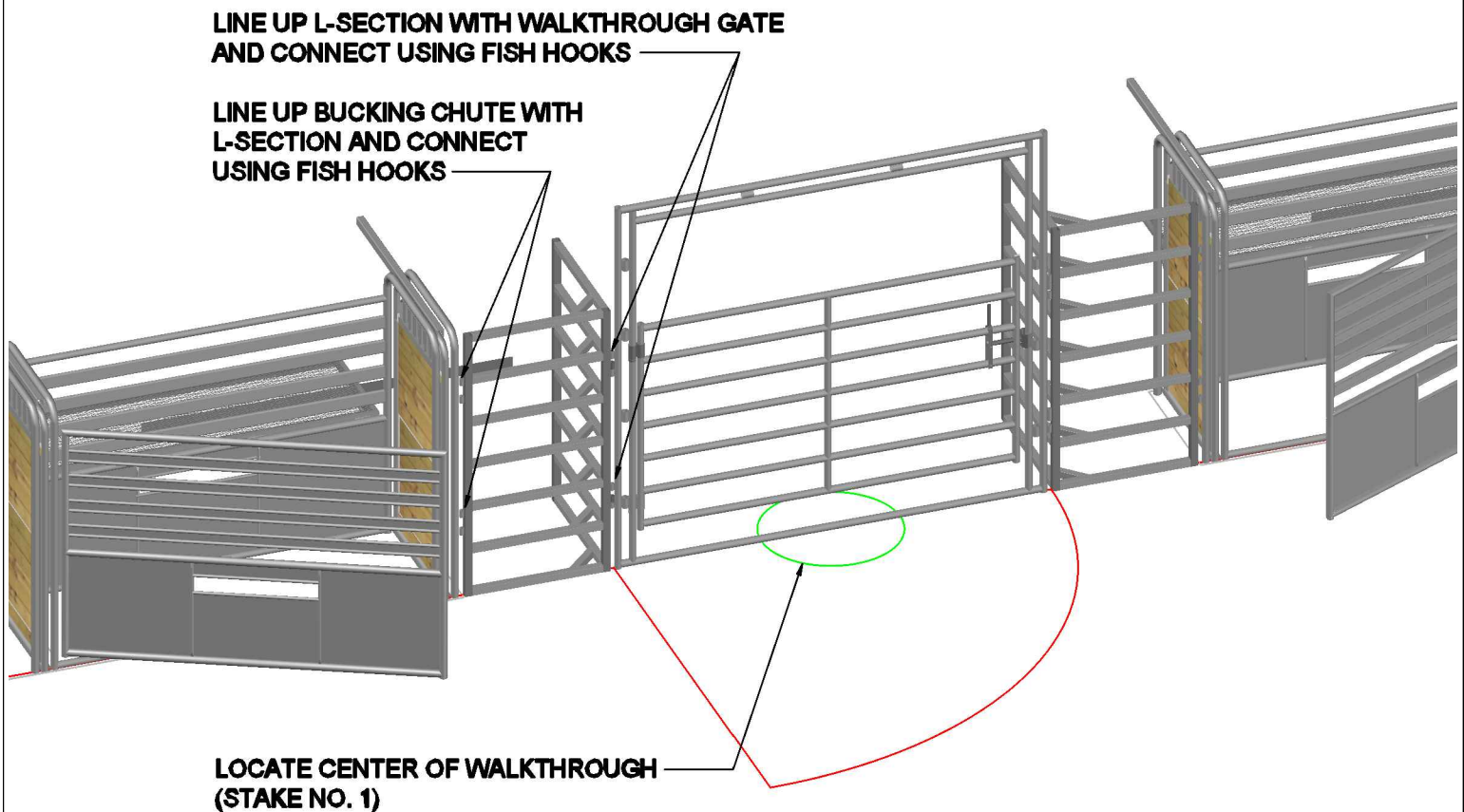

150' x 250' BUCKING ARENA CUSTOM PANEL LOCATIONS

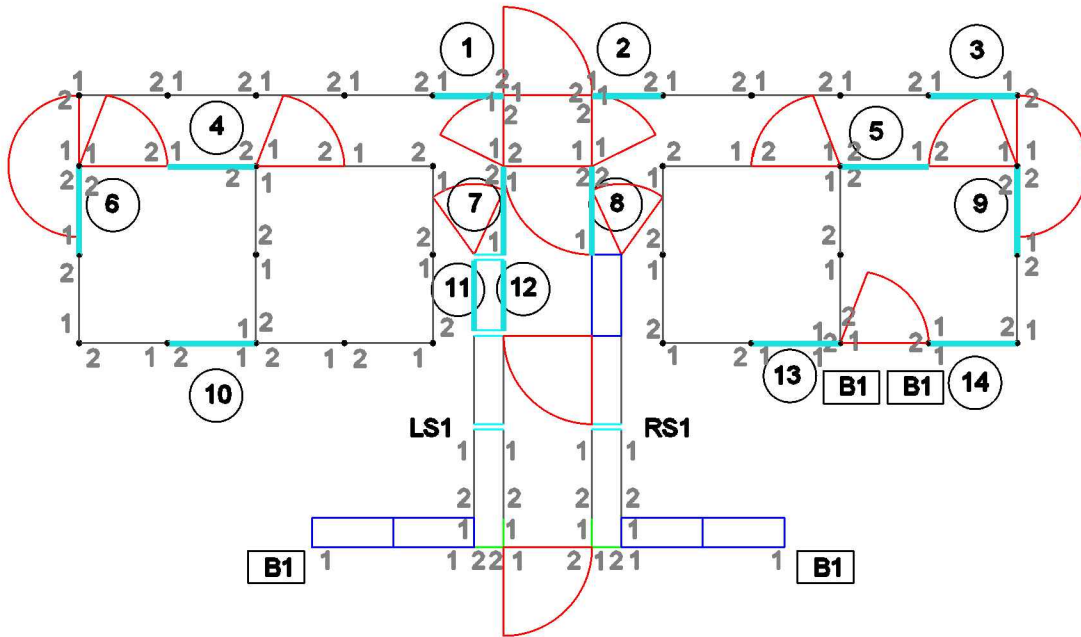

NOTE:
CUSTOM PANEL NUMBERS ARE
LOCATED ON PANEL LEG

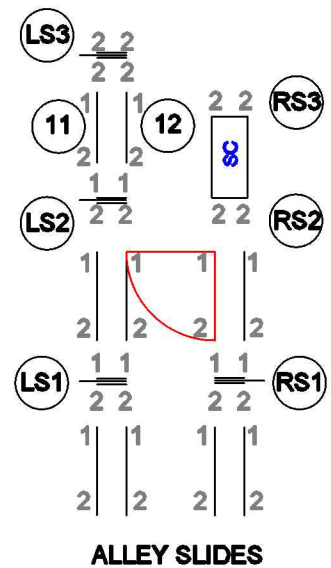

LEGEND

- 1** CUSTOM PANEL
- B1** SPECIAL POST
- 2** DOUBLE SPOOLS
- 1** SINGLE SPOOLS

TOP OFF PANEL VIEW LOOKING DOWN

8' PANELS	1	SINGLE	DOUBLE SINGLE	
	2	SINGLE SINGLE	DOUBLE	
	3	SINGLE	SINGLE	
	4	SINGLE	DOUBLE DOUBLE	
	5	DOUBLE DOUBLE	SINGLE	
	6	SINGLE	DOUBLE DOUBLE	
	7	SINGLE	DOUBLE SINGLE	
	8	SINGLE	DOUBLE DOUBLE	
	9	SINGLE	DOUBLE DOUBLE	
	10	DOUBLE	SINGLE SINGLE	
	11	SINGLE	DOUBLE (7'-6" LENGTH)	
	12	SINGLE	DOUBLE (7'-6" LENGTH)	
	13	SINGLE	SINGLE DOUBLE SINGLE	
	14	SINGLE SINGLE	DOUBLE	
				8' PANELS

150' x 250' BUCKING ARENA SPOOL PLACEMENT LOCATIONS

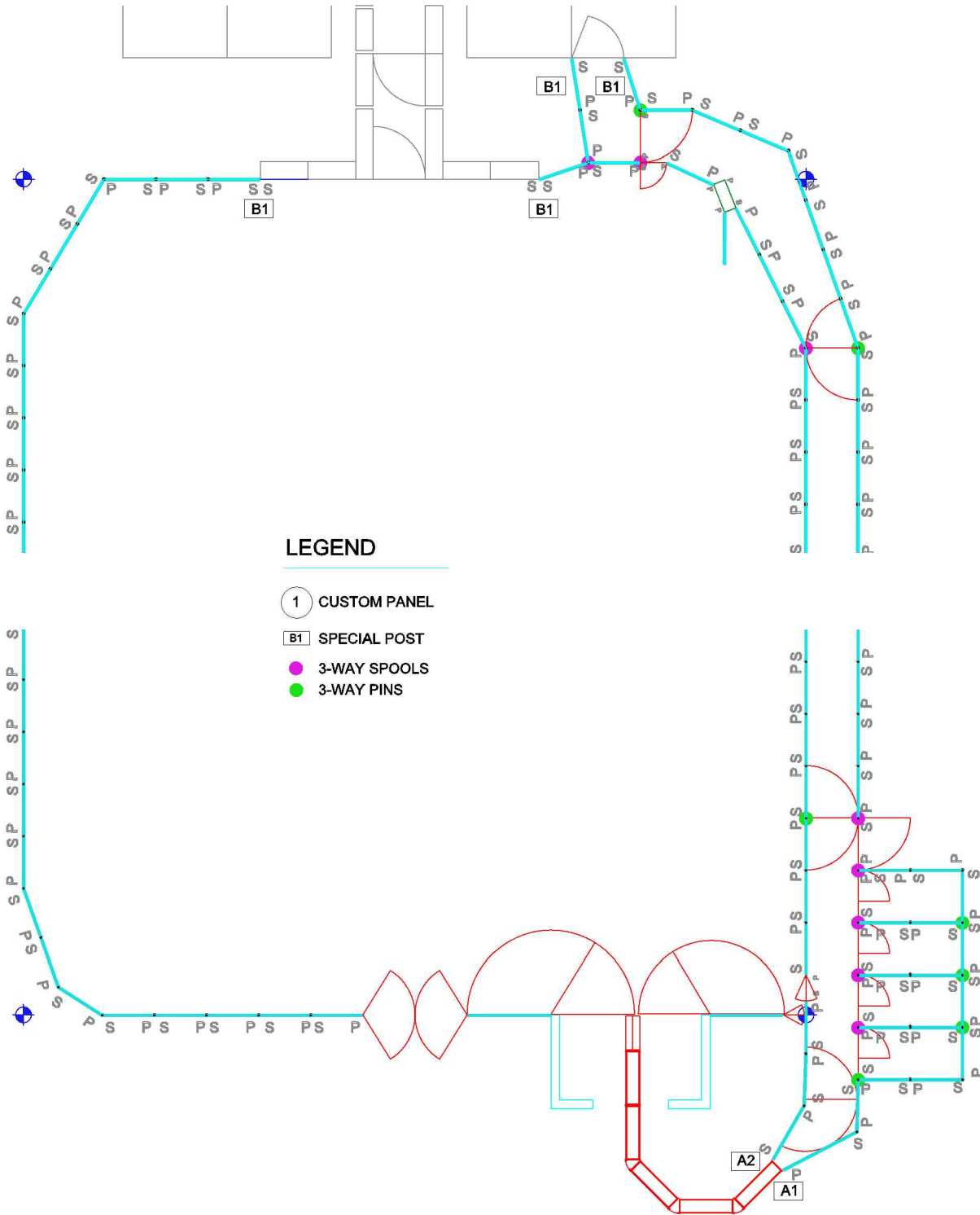

150' x 250' BUCKING ARENA ROPING CHUTE LOCATIONS

Position the BACK Corner **A** of the Roping Chute at the dimension shown below:

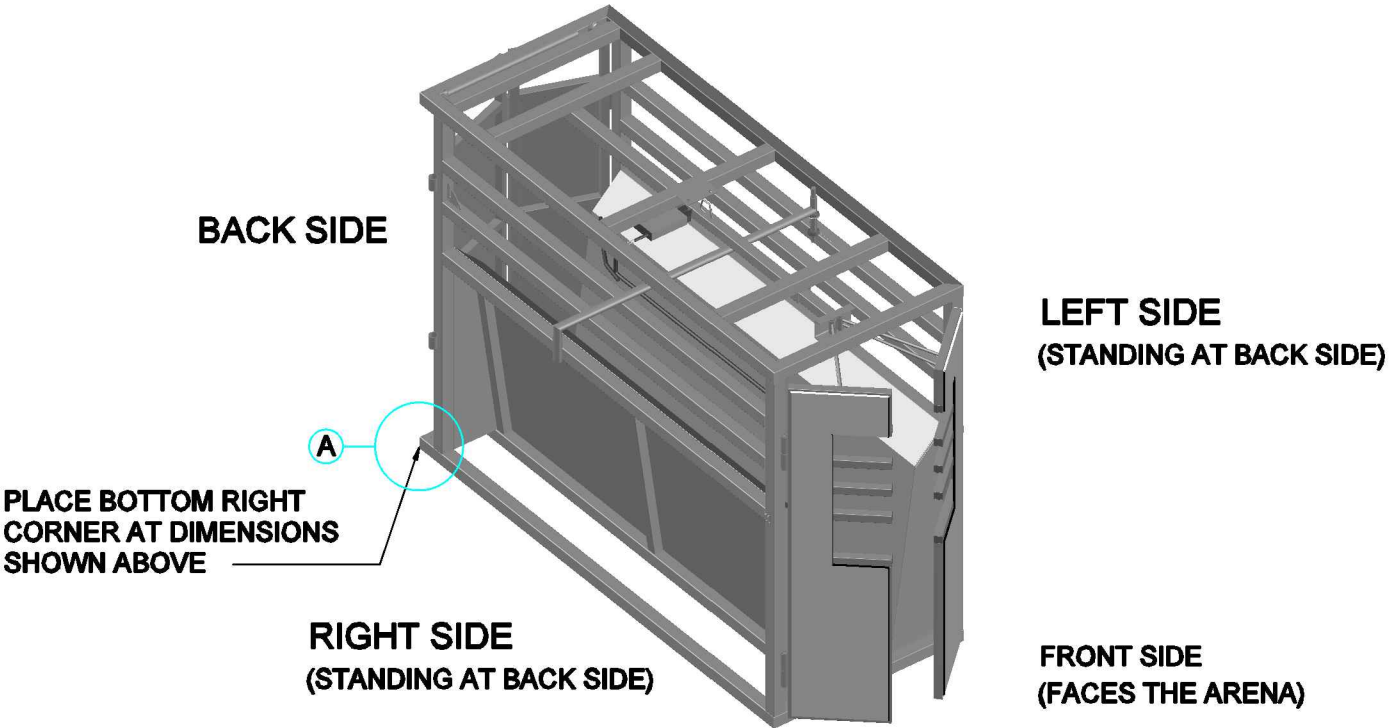
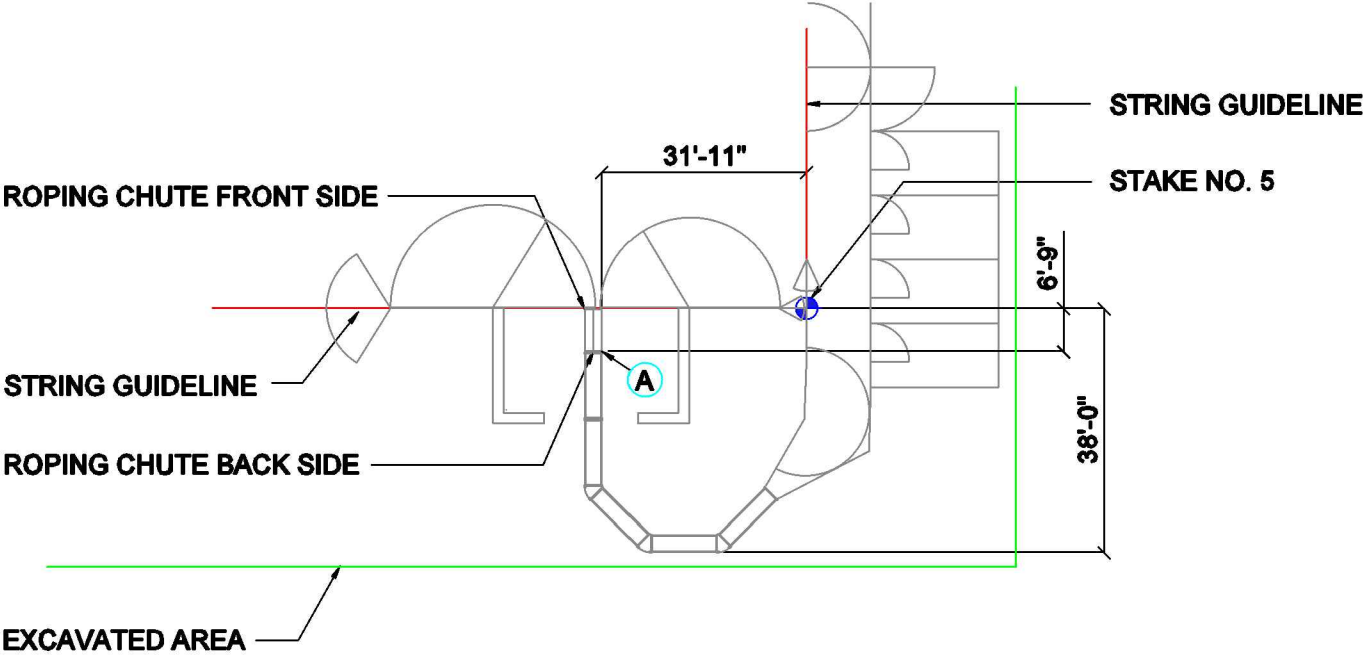

EXTENSION TO CHUTE CONNECTION

1.) Slide 5" U-BARS into CHUTE and EXTENSION spools.

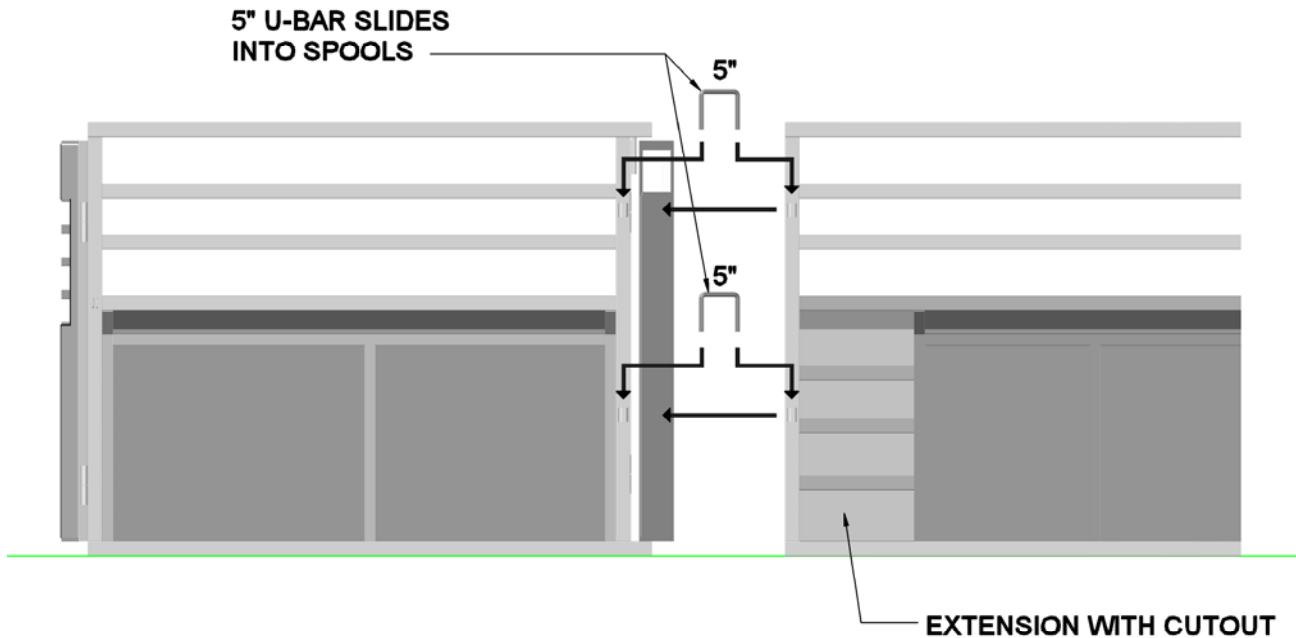

ROPING CHUTE LEFT SIDE

CHUTE EXTENSION

LEFT SIDE STANDING BEHIND THE CHUTE
EXTENSION TO LEFT SIDE CHUTE CONNECTION w/ 5" U-BARS

EXTENSION TO CHUTE CONNECTION

1.) Slide 5" U-BARS into CHUTE and EXTENSION spools.

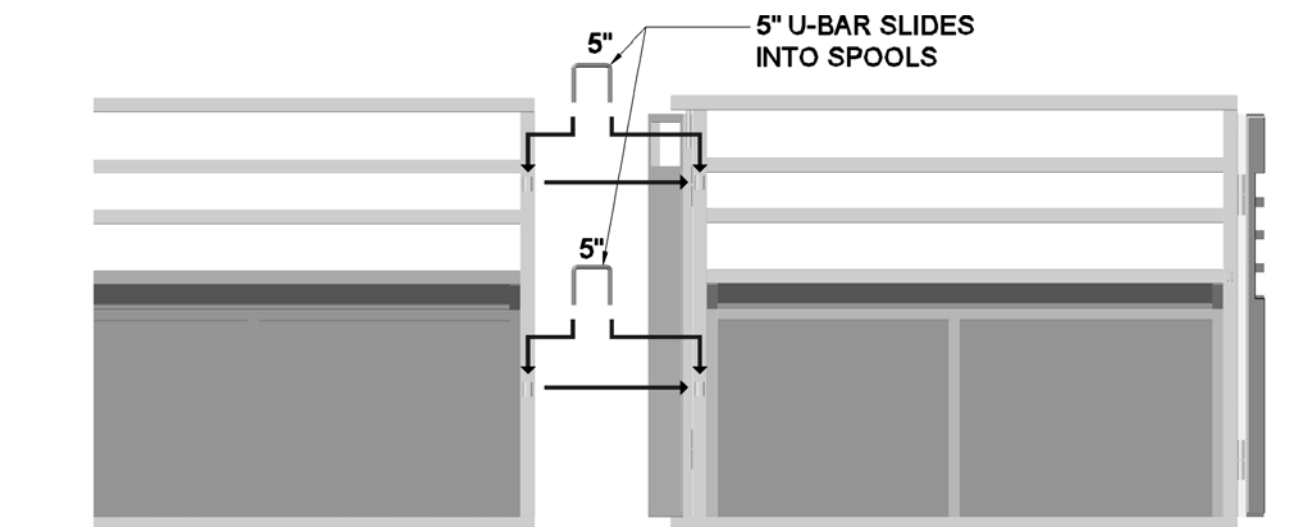

CHUTE EXTENSION

ROPING CHUTE RIGHT SIDE

RIGHT SIDE STANDING BEHIND THE CHUTE
EXTENSION TO RIGHT SIDE CHUTE CONNECTION w/ 5" U-BARS

EXTENSION TO CHUTE CONNECTION

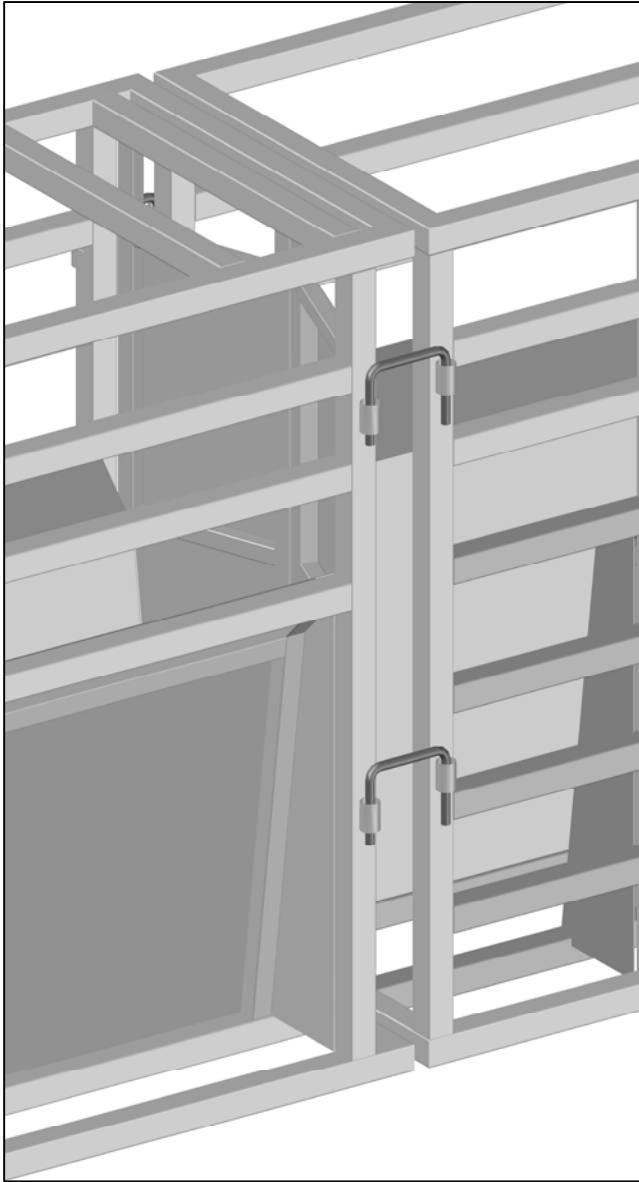

ROPING CHUTE LEFT SIDE
(1/2" x 5" U-BAR)

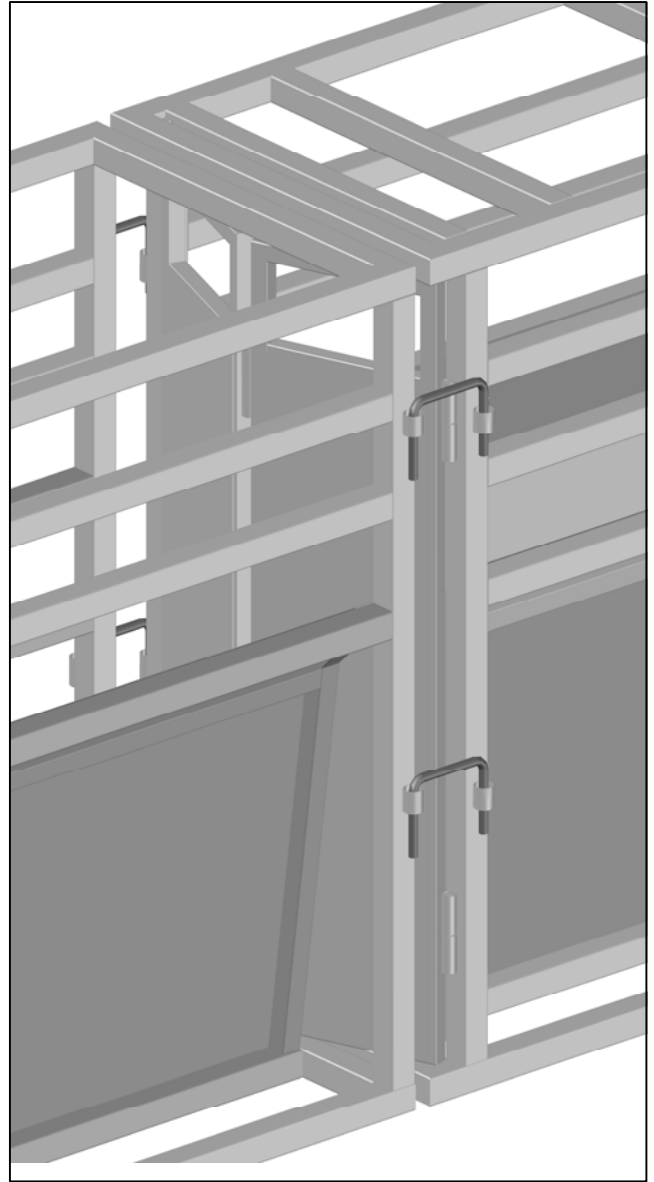

ROPING CHUTE RIGHT SIDE
(1/2" x 5" U-BAR)

STANDING BEHIND CHUTE
LEFT AND RIGHT EXTENSION TO CHUTE U-BAR CONNECTIONS

PANEL TO PANEL CONNECTION

(SPOOL TO PIN)

SPOOL TO PIN PANEL CONNECTION

1. SLIGHTLY TILT UNCONNECTED PANEL AND PLACE BOTTOM SPOOL OVER OTHER PANELS BOTTOM PIN.
2. LIFT TOP PIN AND POSITION PANEL SPOOL UNDER PIN SIDE AND RELEASE PIN.
3. PANEL SHOULD NOW BE CONNECTED. YOU CAN ADJUST ONE PANEL 90° FOR BALANCE.

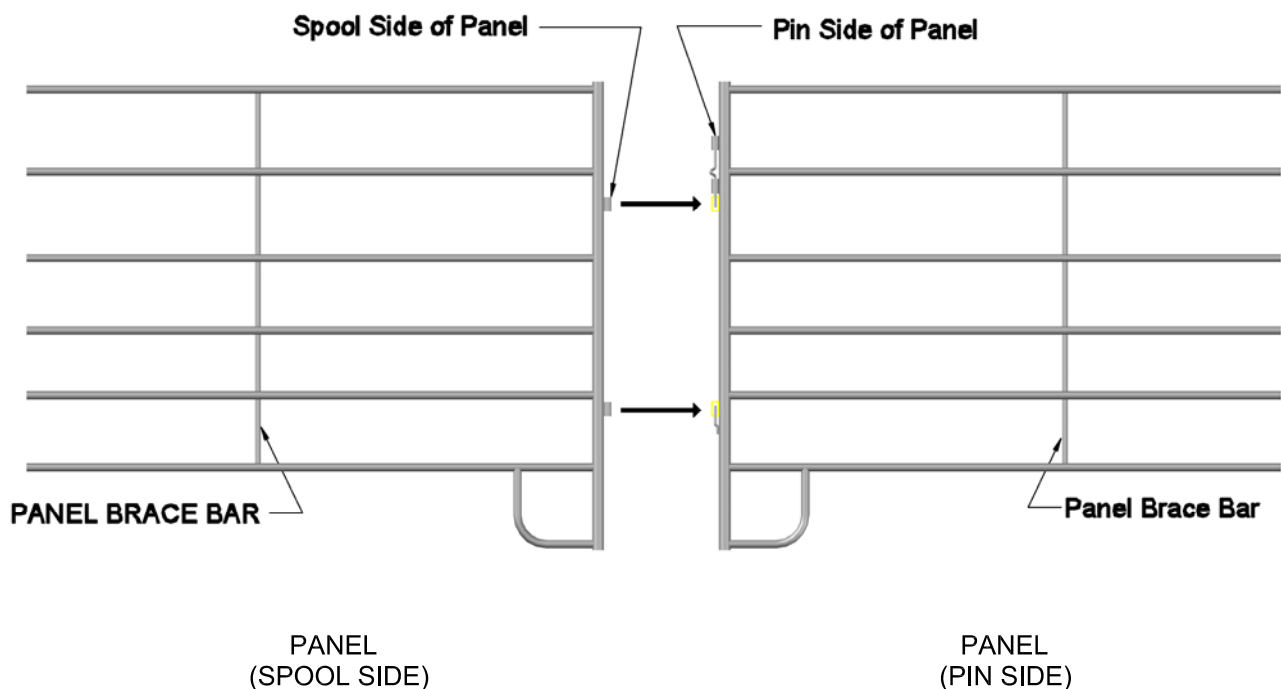

NOTE: WHEN PLACING PANELS - THE PANEL BRACE BAR FACES OUTSIDE OF THE ARENA AREA

SPOOL TO PIN PANEL TO PANEL CONNECTION

PANEL TO STRIPPING CHUTE CONNECTION

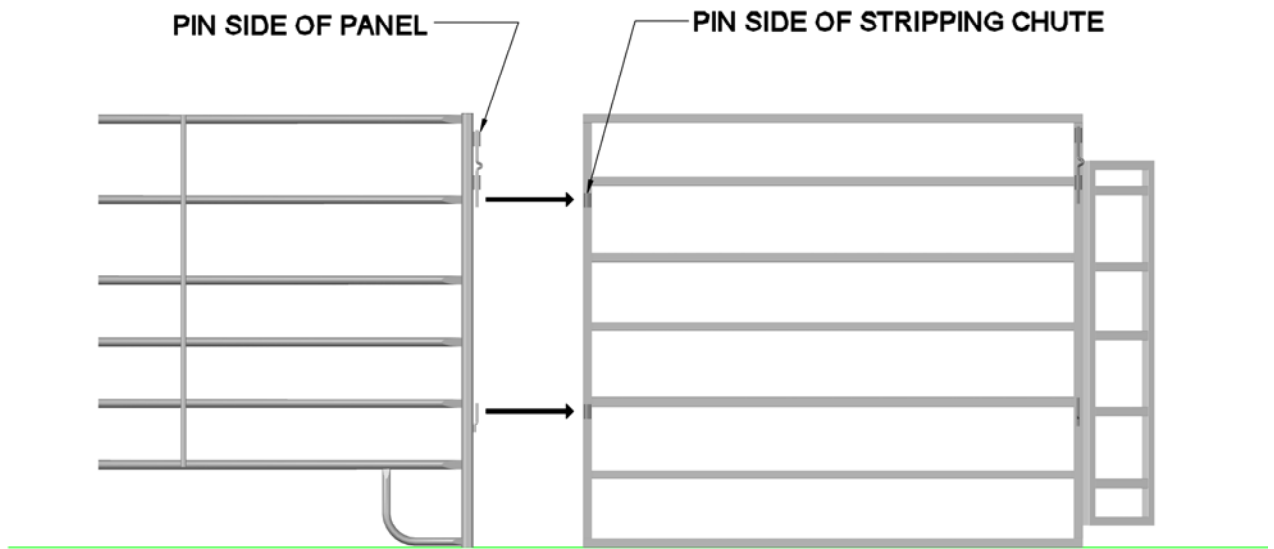

**PANEL
(PIN SIDE)**

STRIPPING CHUTE

PANEL TO STRIPING CHUTE CONNECTION

PANEL TO STRIPPING CHUTE

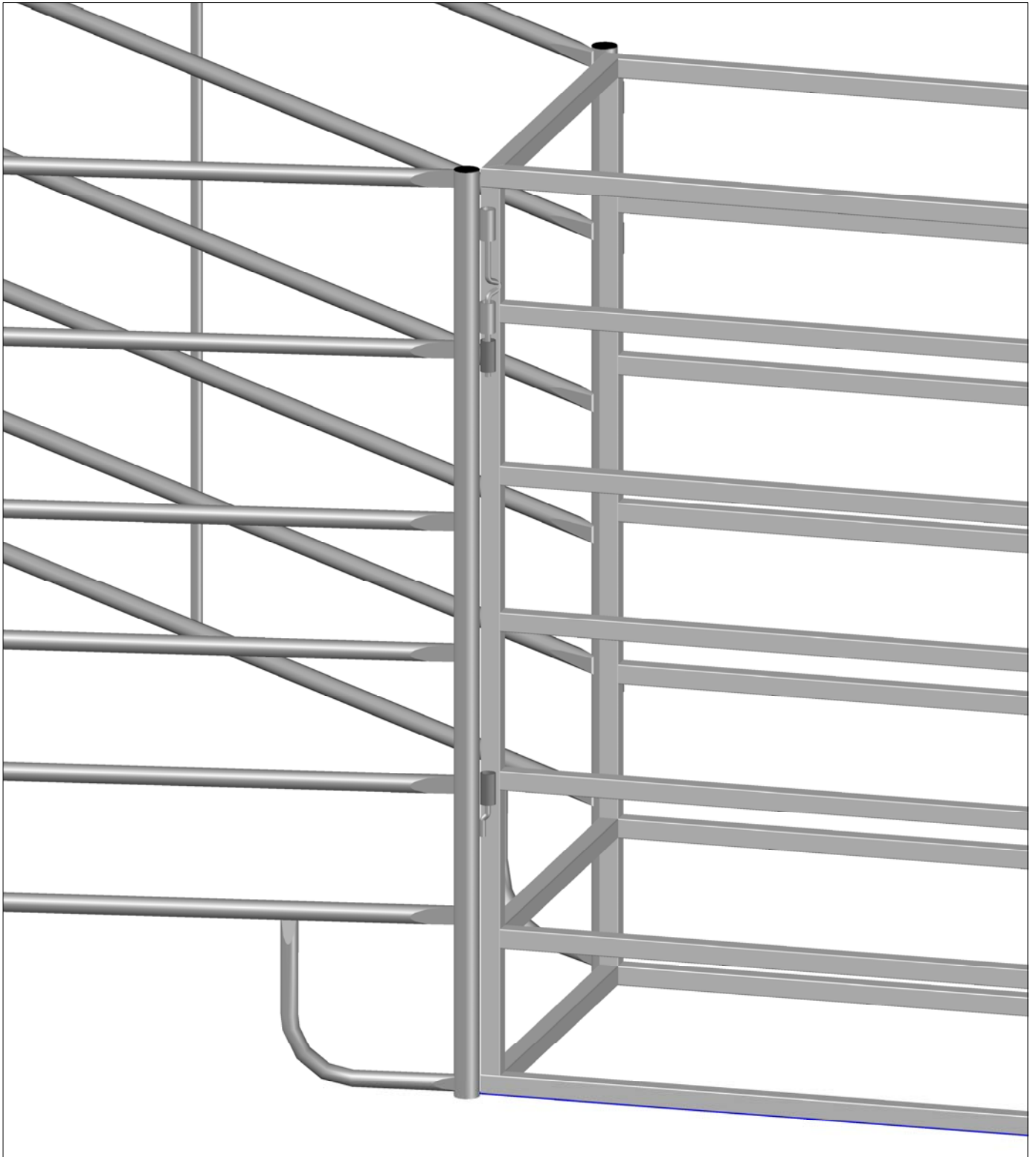

PANEL TO STRIPPING CHUTE CONNECTIONS

PANEL TO STRIPPING CHUTE CONNECTION w/ POST S1

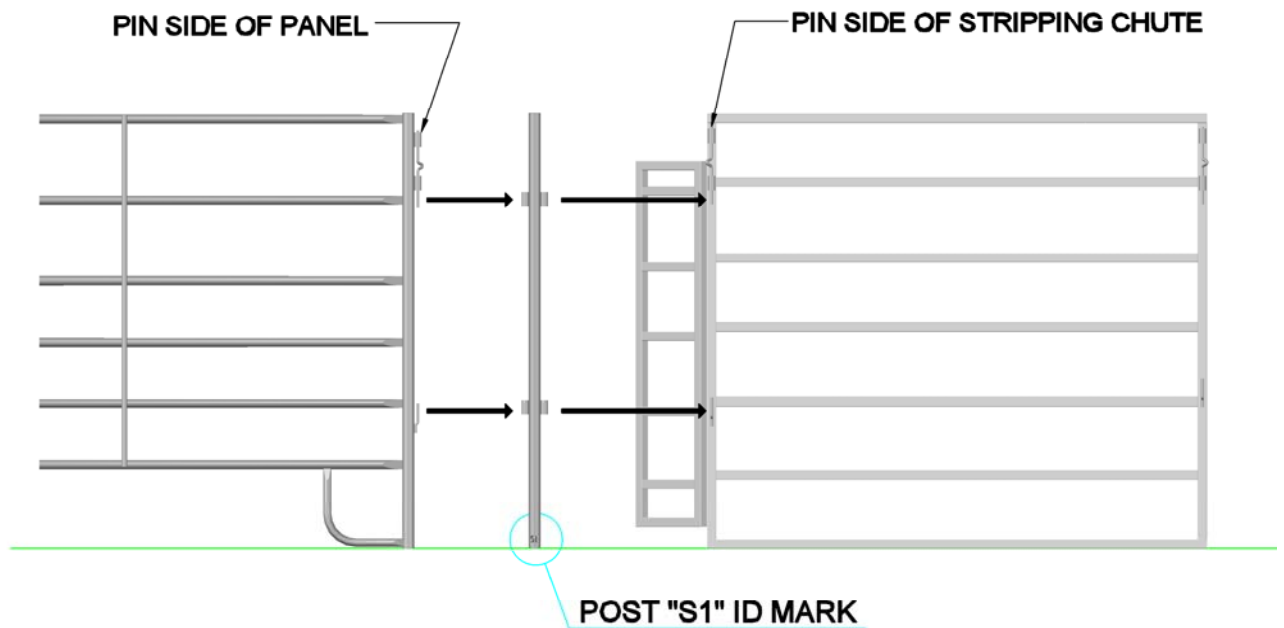

PANEL
(PIN SIDE)

POST S1

STRIPPING CHUTE

PANEL TO STRIPPING CHUTE CONNECTION w/ POST S1

PANEL TO STRIPPING CHUTE CONNECTION w/ POST S1

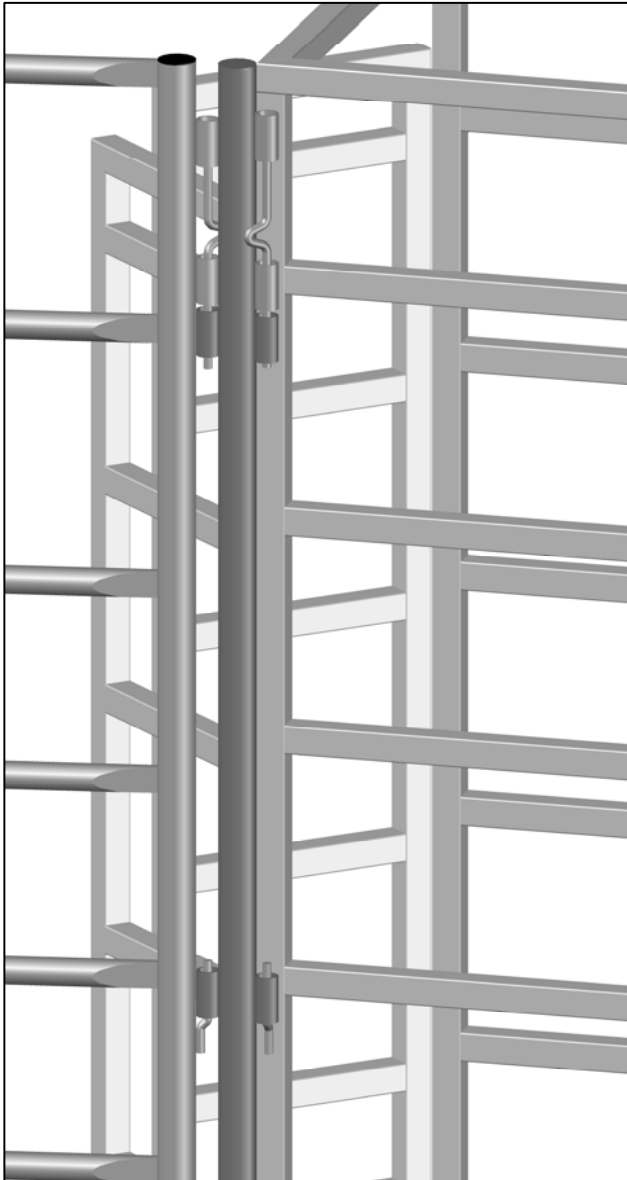

PANEL TO FRONT OF STRIPPING
CHUTE USING POST S1



PANEL TO REAR OF STRIPPING
CHUTE (PIN TO SPOOL)

PANEL TO STRIPPING CHUTE CONNECTIONS